

# ETHANOL INDUSTRY

## BIOFUEL & DISTILLERY OPERATIONS

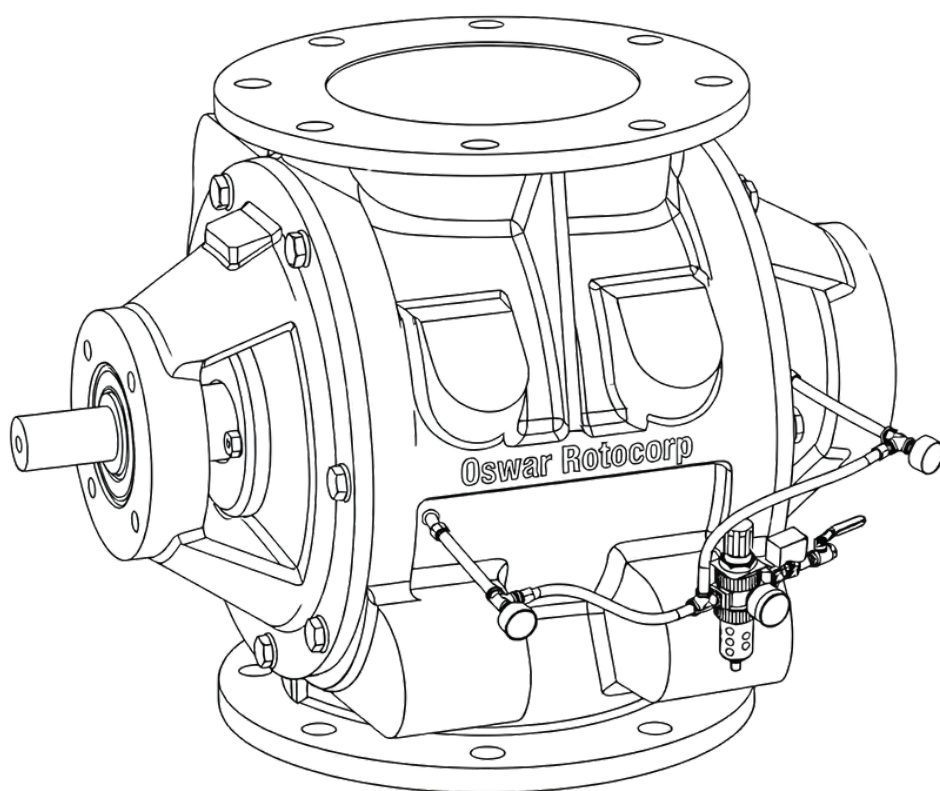
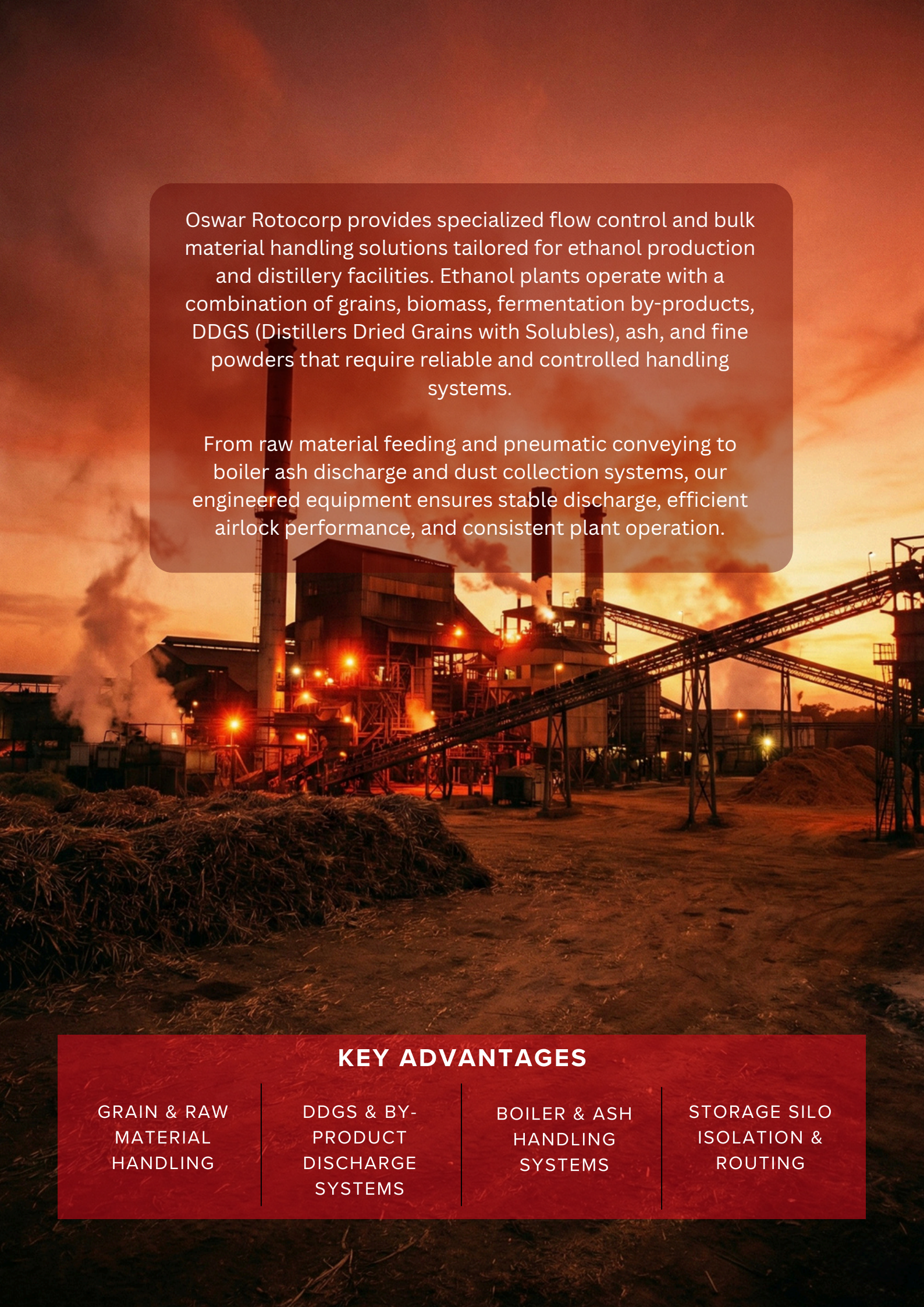

**OSWAR**  
rotocorp

A photograph of an ethanol production facility at sunset. The sky is a mix of orange, red, and yellow. In the foreground, there are large piles of harvested grain, likely corn cobs. The facility itself is a complex of industrial structures, including tall chimneys, conveyor belts, and large storage silos. Some parts of the facility are illuminated with warm lights, creating a glowing effect against the darkening sky. The overall scene conveys a sense of industrial activity and the natural process of grain harvesting.

Oswar Rotocorp provides specialized flow control and bulk material handling solutions tailored for ethanol production and distillery facilities. Ethanol plants operate with a combination of grains, biomass, fermentation by-products, DDGS (Distillers Dried Grains with Solubles), ash, and fine powders that require reliable and controlled handling systems.

From raw material feeding and pneumatic conveying to boiler ash discharge and dust collection systems, our engineered equipment ensures stable discharge, efficient airlock performance, and consistent plant operation.

## KEY ADVANTAGES

GRAIN & RAW  
MATERIAL  
HANDLING

DDGS & BY-  
PRODUCT  
DISCHARGE  
SYSTEMS

BOILER & ASH  
HANDLING  
SYSTEMS

STORAGE SILO  
ISOLATION &  
ROUTING

# BUILT FOR CONTINUOUS BIOFUEL OPERATIONS

Ethanol and distillery operations demand equipment capable of handling powders, granules, and biomass materials in continuous production cycles. Our solutions are constructed using reinforced housings, optimized rotor designs, and reliable sealing configurations to ensure consistent discharge and airlock efficiency. Precision-engineered Rotary Valves support stable feeding in pneumatic conveying systems and dust extraction units. Heavy-duty bearing systems and wear-resistant materials enhance durability in abrasive and high-load environments.

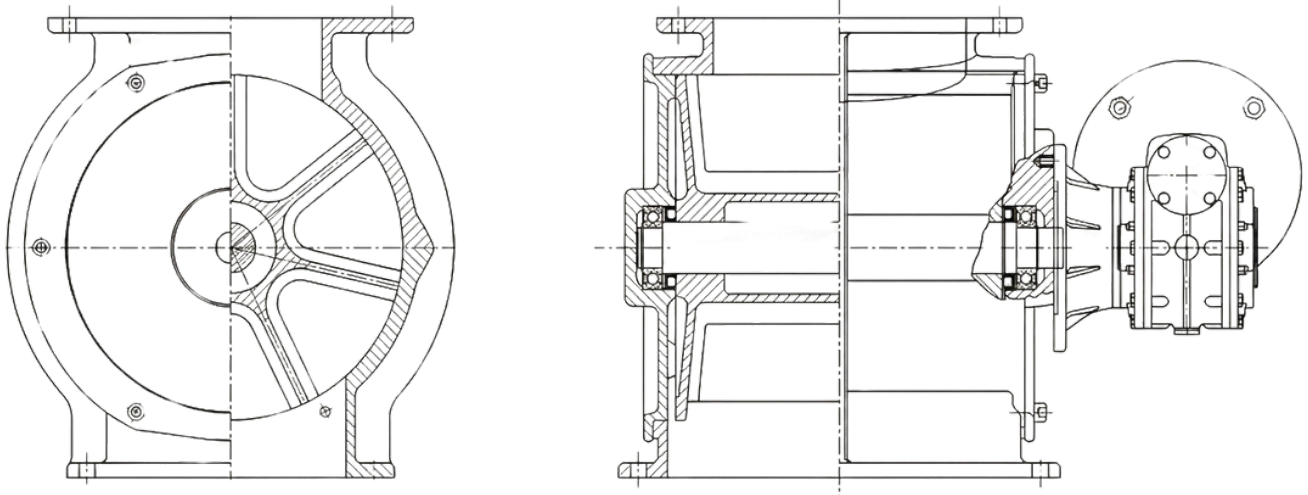

## ENGINEERING FEATURES

- Rotary Valves for Grain & Powder Discharge
- Heavy-Duty Rotary Valves for DDGS Handling
- Pneumatic Pressure Rotary Valves for Conveying Systems
- Slide Gate Valves for Silo Isolation
- Diverter Valves for Multi-Line Distribution

# SUPPORTING EFFICIENT BIOFUEL PRODUCTION

- **Stable & Controlled Material Feeding**
- **Improved Airlock Efficiency**
- **Reduced Dust & Material Leakage**
- **Reliable Performance in Continuous Operation**
- **Extended Equipment Service Life**
- **Lower Maintenance Frequency**



# OSWAR

## rotocorp

### **Corporate Office**

Jaipur, Rajasthan India  
Nagpur, Maharashtra India

### **Sales Inquiries**

[info@oswarrotocorp.com](mailto:info@oswarrotocorp.com)

### **Helpline**

[+44 7917 128505](tel:+447917128505) | +91 77422 36474

**Copyright** © 2026 OSWAR ROTOCORP. All Rights Reserved. OSWAR® is a registered trademark of **OSWAR ROTOCORP**. This brochure makes no offers, representations or warranties (express or implied), and information and data contained in this brochure are for general reference only and may change at any time.